

## 所有配件及售價 ALL PARTS AND PRICES

闊 × 深 × 高 Width × Depth × Height	單座位梳化床 Chair-bed	單座位梳化床 Chair-bed	單座位梳化床 Chair-bed
梳化床框連床褥及椅套 Complete with mattress and cover	<b>LÖVÅS</b> 泡膠床褥 foam mattress	<b>MURBO</b> 泡膠床褥 foam mattress	<b>HÅVET</b> 乳膠床褥 latex mattress
<b>RANSTA</b> 椅套 Cover	淨椅套 Cover only	淨椅套 Cover only	淨椅套 Cover only
白色 White	<b>\$1,090</b> 001.813.12	<b>\$1,390</b> 001.813.12	<b>\$1,590</b> 001.813.12
<b>EBBARP</b> 椅套 Cover	<b>\$300</b> 003.245.80	<b>\$300</b> 003.245.80	<b>\$300</b> 003.245.80
黑色/白色 Black/white	<b>\$1,250</b>	<b>\$1,550</b>	<b>\$1,750</b>
<b>VALLARUM</b> 椅套 Cover	<b>\$450</b> 003.242.26	<b>\$450</b> 003.242.26	<b>\$450</b> 003.242.26
湖水綠色 Turquoise	<b>\$1,400</b>	<b>\$1,700</b>	<b>\$1,900</b>
桃紅色 Cerise	<b>\$1,400</b>	<b>\$1,700</b>	<b>\$1,900</b>
灰色 Grey	<b>\$1,400</b>	<b>\$1,700</b>	<b>\$1,900</b>
淨梳化床框 Frame only	<b>\$450</b> 401.586.54		
淨床褥 Mattress only	<b>\$500</b> 601.607.12	<b>\$800</b> 201.607.14	<b>\$1,000</b> 201.607.09
貯物箱 Storage box (47×55×20.5cm)	<b>\$179.9</b> 001.924.57		

闊 × 深 × 高 Width × Depth × Height	兩座位梳化床 Sofa-bed	兩座位梳化床 Sofa-bed	兩座位梳化床 Sofa-bed
梳化床框連床褥及椅套 Complete with mattress and cover	<b>LÖVÅS</b> 泡膠床褥 foam mattress	<b>MURBO</b> 泡膠床褥 foam mattress	<b>HÅVET</b> 乳膠床褥 latex mattress
<b>RANSTA</b> 椅套 Cover	淨椅套 Cover only	淨椅套 Cover only	淨椅套 Cover only
白色 White	<b>\$1,390</b> 101.813.16	<b>\$1,790</b> 101.813.16	<b>\$2,090</b> 101.813.16
<b>EBBARP</b> 椅套 Cover	<b>\$400</b> 403.245.83	<b>\$400</b> 403.245.83	<b>\$400</b> 403.245.83
黑色/白色 Black/white	<b>\$1,550</b>	<b>\$1,950</b>	<b>\$2,250</b>
<b>VALLARUM</b> 椅套 Cover	<b>\$550</b> 303.234.09	<b>\$550</b> 303.234.09	<b>\$550</b> 303.234.09
湖水綠色 Turquoise	<b>\$1,700</b>	<b>\$2,100</b>	<b>\$2,400</b>
桃紅色 Cerise	<b>\$1,700</b>	<b>\$2,100</b>	<b>\$2,400</b>
灰色 Grey	<b>\$1,700</b>	<b>\$2,100</b>	<b>\$2,400</b>
淨梳化床框 Frame only	<b>\$550</b> 101.586.55		
淨床褥 Mattress only	<b>\$600</b> 801.607.11	<b>\$1,000</b> 401.607.13	<b>\$1,300</b> 401.607.08
貯物箱 Storage box (96×55×20.5cm)	<b>\$279.9</b> 801.924.58		

產品及組件或須組裝。詳情可參閱價目標籤。產品資料只供參考。詳情請向店務員查詢或瀏覽IKEA.com.hk。

如有爭議，宜家家居保留最終之決定權。

All units require assembly, please refer to the price tag. Product information is for reference only, please contact our staff or browse IKEA.com.hk/en. In case of any dispute, IKEA shall have the right of final decision.

© Inter IKEA Systems B.V. 2015-2019 AUG

## 購物指南 BUYING GUIDE

# LYCKSELE

## 梳化床系列 Sofa-bed series

### 款式

單座位梳化床  
兩座位梳化床  
貯物箱

### MODELS

Chair-bed  
Sofa-bed  
Storage box



多款椅套款式  
Choice of cover



可更換椅套  
Removable cover



可機洗椅套  
Washable cover

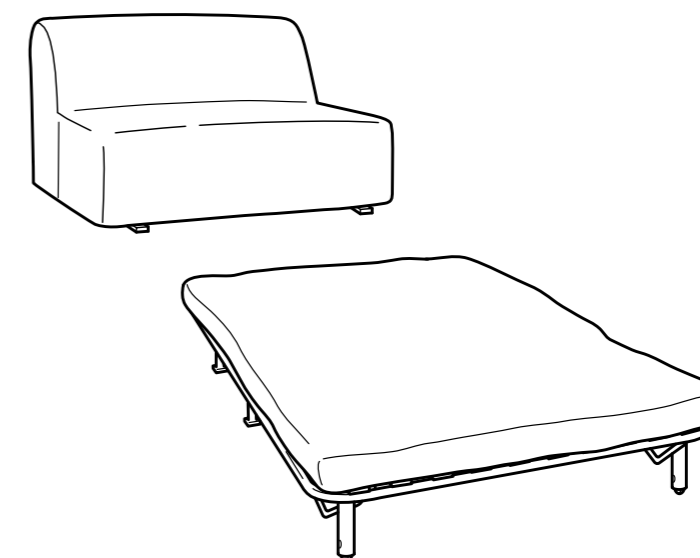

### 擺放容易 使用簡單

LYCKSELE梳化床能安放於任何房間，幾個步驟便能變成睡床，或坐或躺也同樣寫意。床褥和椅套可自由配搭，盡展個人風格。椅套可拆下清洗，您也可以換上新椅套換換心情。LYCKSELE梳化床備有兩種尺寸，分別是單人床及雙人床，兩款均可添置床底貯物箱。

### 自選床褥

您喜歡軟一點，還是硬一點的床褥？LYCKSELE梳化床讓您隨意挑選心頭好。備有3款床褥以供選擇，坐上去或躺下去截然不同。歡迎親身試試，把最適合的一款帶回家，從此日夜也有舒適享受。

### Easy to place, easy to use

LYCKSELE sofa-bed is perfect when you want to be able to both sit and sleep. It's easy to fit in any room and easy to convert to a bed. You choose the mattress and cover yourself, so you can make it just the way you like it. You can even take off the cover to wash it – or to have a little fun by changing to a new cover. You're also free to choose between two widths when you buy your LYCKSELE. If you need a double bed, choose the sofa-bed. If a single bed is big enough, there's also a chair-bed. Both can be complemented with a practical storage box for bed linen.

### You choose the mattress

Do you like a soft or firm mattress? With LYCKSELE sofa-bed, you choose the mattress you like best. There are three mattresses to choose between and they feel quite different when you sit or lie on them. Try them out to find the one that's most comfortable for you. Once you do, you will have a pleasant place to be – both day and night.



發掘更多資訊 See more at:  
IKEA.com.hk



## 如何打開 HOW TO CONVERT

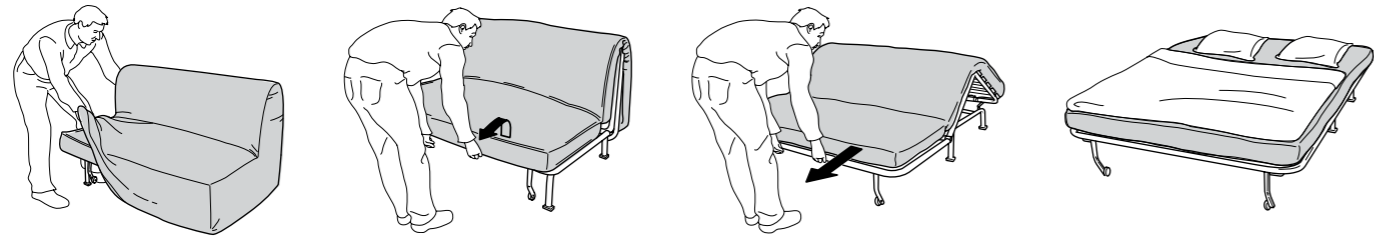

### 尺寸 SIZE:

單座位梳化床 Chair-bed: 80×100cm

兩座位梳化床 Sofa-bed: 142×100cm

LYCKSELE梳化床瞬間即可轉換成床，只需除掉布套，拉起座位，梳化床便可變成140×188cm舒適雙人床。而單座位梳化床則可變成80×188cm單人床。拉起床腳，推至最盡便可摺起睡床。再次向下推時，睡床就會整齊摺起，不需額外收拾。這時，LYCKSELE又變回梳化了！

### 尺寸 SIZE:

單座位梳化床 Chair-bed: 80×188cm

兩座位梳化床 Sofa-bed: 142×188cm

It takes a few short seconds to convert LYCKSELE sofa-bed into a bed. Just remove the cover and pull out the seat. The sofa-bed turns into a comfortable 140×188cm double bed. The chair-bed turns into an 80×188cm single bed. To fold up the bed, just lift up the foot end as far as it goes. When you push it down again, the bed will fold up neatly, almost without any help from you. It's a sofa again!

## 購物小提示 GOOD TO KNOW

### 嚴格布料測試

宜家家居會測試梳化及扶手椅的布套，確保耐用。測試布料的抗磨能力時，會以機器將布料與另一塊布料大力磨擦，若布料可在測試中磨擦15,000次，便適合用作製造日常使用的傢具，若可在測試中磨擦30,000次以上，則證明其抗磨損能力極高。由於所有布料也會受陽光影響，我們亦會檢查布料有效防褪色的能力。

### 耐用程度

嚴格測試可反映布套的耐用程度，但未能完全反映布料品質，因為耐用程度亦視乎物料、構造及使用習慣而定。表面平滑的厚身密織布料抗磨能力較高，混合天然及人造纖維的布料則比純天然纖維布料更耐磨，而染紗布料亦比印花布料更耐用。骯髒的布套比乾淨的布套更易磨損。當然，使用梳化的方式亦有影響。

### Our fabrics have been tested

At IKEA we test the fabric covers on our sofas and armchairs so you can be sure they're durable. The fabric's ability to resist abrasion is tested by using a machine to rub it against another fabric while applying firm pressure. A fabric that can take 15,000 cycles is suitable for furniture that must withstand everyday life at home – and if it can take more than 30,000 cycles, it is very resistant to abrasion. All fabrics are sensitive to sunlight, which is why we also check that our fabrics resist fading effectively.

### Durable in different ways

Tough tests are an important way to check the durability of our fabric covers, but they don't tell the whole story. Durability also depends on materials, construction and manner of use. Heavy, tightly woven fabrics with a flat surface are most resistant to abrasion. Fabrics with a mixture of natural and synthetic fibres can withstand abrasion better than fabrics with only natural fibres. Yarn-dyed fabrics are more durable than fabrics with printed patterns. And a dirty cover wears out faster than a clean one. The fabric is also affected by how you use your sofa of course.

		清洗指引 Washing instructions	抗磨能力(次數) Resistance to abrasion (cycles)
<b>RANSTA</b>	漂白棉椅套。 Bleached cotton fabric.		30,000
<b>EBBARP</b>	印花圖案的棉布套。 Cotton fabric with a graphic printed pattern.		20,000
<b>VALLARUM</b>	柔軟全聚酯纖維布套。 Soft, quilted cover in 100% polyester (microfibre).		30,000

## 舒適床褥 COMFORT MATTRESSES

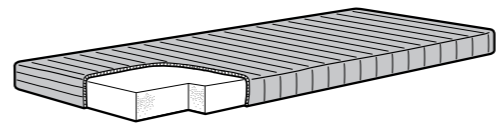

### LÖVÅS

泡膠床褥堅挺柔軟，為身體提供足夠承托，同時讓您睡得舒適。床褥厚10cm，附有可拆下乾洗的床褥套。  
A firm, yet supple polyurethane foam mattress that will provide your body with both support and sleeping comfort. The mattress is 10cm thick and has a removable, dry-clean cover.

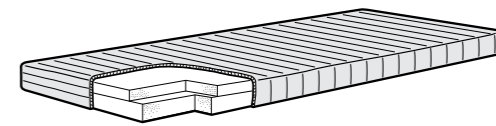

### MURBO

床褥頂層的高彈性泡膠能緊貼身體線條，令脊骨維持挺直，身體更加放鬆，並使床褥加倍耐用。底層則為泡膠。  
床褥厚10cm，附有可拆下機洗的床褥套。  
The top layer of high resilient foam shapes itself to your body, allowing your spine to remain straight and your sleeping position to be more relaxed. The resilient foam also makes the mattress very durable. The bottom layer consists of polyurethane foam. The mattress is 10cm thick and has a removable and machine washable cover.

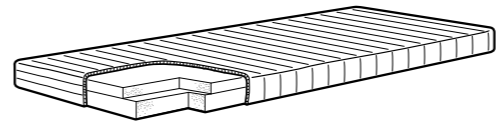

### HÅVET

乳膠及高彈性泡膠彈性良好，能緊貼身體曲線提供承托。乳膠有助透氣，自然排走濕氣。這種物料組合亦令床褥更加柔韌，不易變形。頂層為乳膠，底層則為高彈性泡膠。  
床褥厚10cm，附有可拆下機洗的床褥套。  
Latex and high resilient foam combine elasticity with the ability to mould to the contours of your body. Latex is a material which improves air circulation and allows moisture to evaporate naturally. The mix of materials makes the mattress both pliable and long lasting. The top layer consists of latex and the bottom layer of high resilient polyurethane foam. The mattress is 10cm thick and has a removable and machine washable cover.